

Tubular Cable Lugs
Standard Type - Euro Series

- Electrolytic high conductivity copper
- Electro tinned plated
- With/without inspection hole

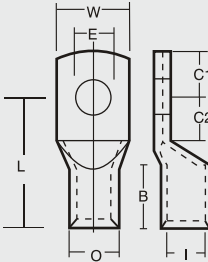

Product Ref.	Conductor Size mm ²	Stud Hole	Dimensions mm								
			E	I	B	W	E	O	C1	C2	L
CS 6-5	6	M 5	3.5	9	10	5.5	6.5	6.5	7.5	21	
CS 6-6	6	M 6			12	6.5		6.5	7.5	21	
CS 6-8	6	M 8			15	8.5		10	10	23	
CS 6-10	6	M 10			17	10.5		12	12	25	
CS 6-12	6	M 12			19	13		13	13	28	
CS 10-5	10	M 5	4.5	10	12	5.5	7	6.5	7.5	22	
CS 10-6	10	M 6			12	6.5		6.5	7.5	22	
CS 10-8	10	M 8			15	8.5		10	10	25	
CS 10-10	10	M 10			17	10.5		12	12	27	
CS 10-12	10	M 12			19	13		13	13	29	
CS 16-5	16	M 5	5.5	13	12	5.5	8.5	5.5	6.5	26	
CS 16-6	16	M 6			12	6.5		6.25	7.5	27	
CS 16-8	16	M 8			15	8.5		8.5	9.5	29	
CS 16-10	16	M 10			17	10.5		10.5	11.5	31	
CS 16-12	16	M 12			19	13		12	13	33	
CS 25-5	25	M 5	7	15	14	5.5	10	7.5	7.5	30	
CS 25-6	25	M 6			14	6.5		7.5	7.5	30	
CS 25-8	25	M 8			16	8.5		10	10	32	
CS 25-10	25	M 10			18	10.5		12	12	34	
CS 25-12	25	M 12			19	13		13	13	35	
CS 25-14	25	M 14			21	15		14.5	14.5	38	
CS 35-6	35	M 6	8.5	17	17	6.5	12	7.5	7.5	32	
CS 35-8	35	M 8			17	8.5		10	10	34	
CS 35-10	35	M 10			19	10.5		12	12	37	
CS 35-12	35	M 12			21	13		13	13	38	
CS 35-14	35	M 14			21	15		14.5	14.5	40	
CS 35-16	35	M 16			26	17		16	16	42	
CS 50-6	50	M 6	10	19	20	6.5	14	10	10	37	
CS 50-8	50	M 8			20	8.5		10	10	37	
CS 50-10	50	M 10			20	10.5		12	12	39	
CS 50-12	50	M 12			23	13		13	13	43	
CS 50-14	50	M 14			23	15		14.5	14.5	45	
CS 50-16	50	M 16			28	17		16	16	46	
CS 50-20	50	M 20			30	21		19	19	48	
CS 70-6	70	M 6	12	21	20	6.5	16.5	10	10	43	
CS 70-8	70	M 8			23	8.5		10	10	43	
CS 70-10	70	M 10			23	10.5		12	12	44	
CS 70-12	70	M 12			23	13		13	13	46	
CS 70-14	70	M 14			23	15		14.5	14.5	48	
CS 70-16	70	M 16			28	17		16	16	50	
CS 70-20	70	M 20			30	21		19	19	53	